

XTOOL

Kiosque en libre-service sur pied

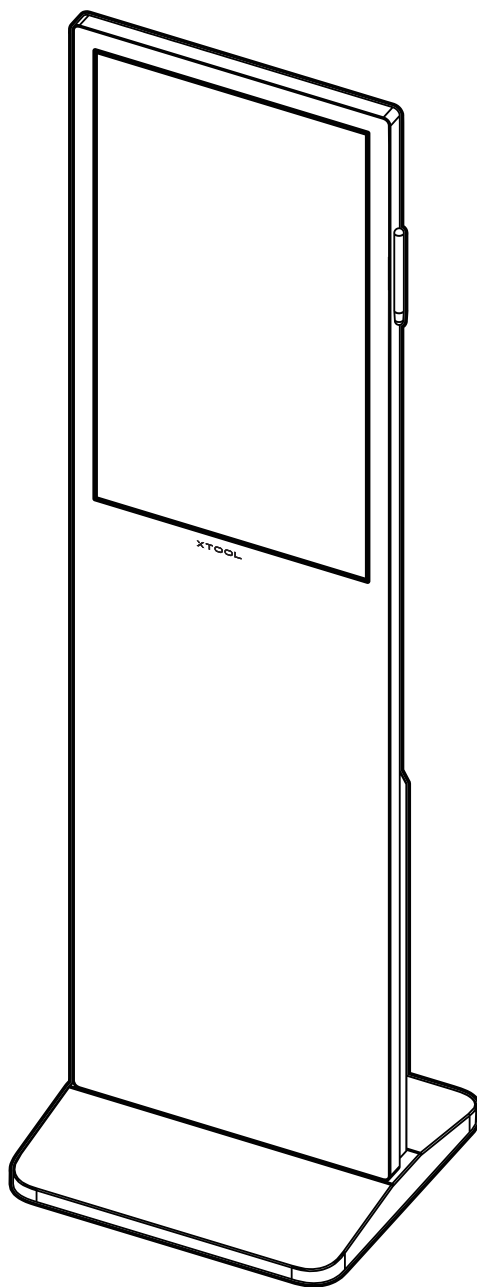

Guide de démarrage rapide

Liste des éléments - - - - - 01

**Découvrez le kiosque en libre-
service sur pied xTool - - - - - 02**

**Installez le kiosque en libre-service - - - - - 04
sur pied xTool**

**Utilisez le kiosque en libre-service - - - - - 06
sur pied xTool**

Liste des éléments

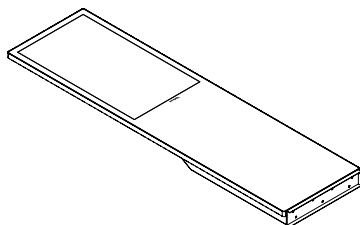

Kiosque en libre-service

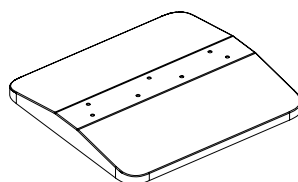

Base de support

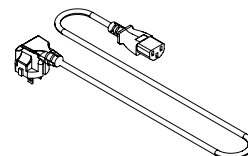

Cordon d'alimentation

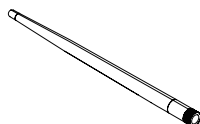

Antenne

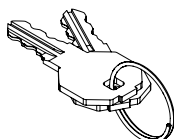

Clé de maintenance

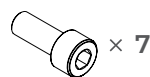

Vis

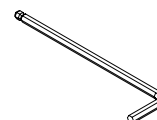

Clé hexagonale

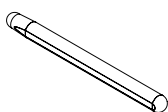

Styler



Guide de démarrage rapide



Consignes de sécurité



Le câble d'alimentation varie selon la région dans laquelle le produit est livré.

Découvrez le kiosque en libre-service sur pied xTool

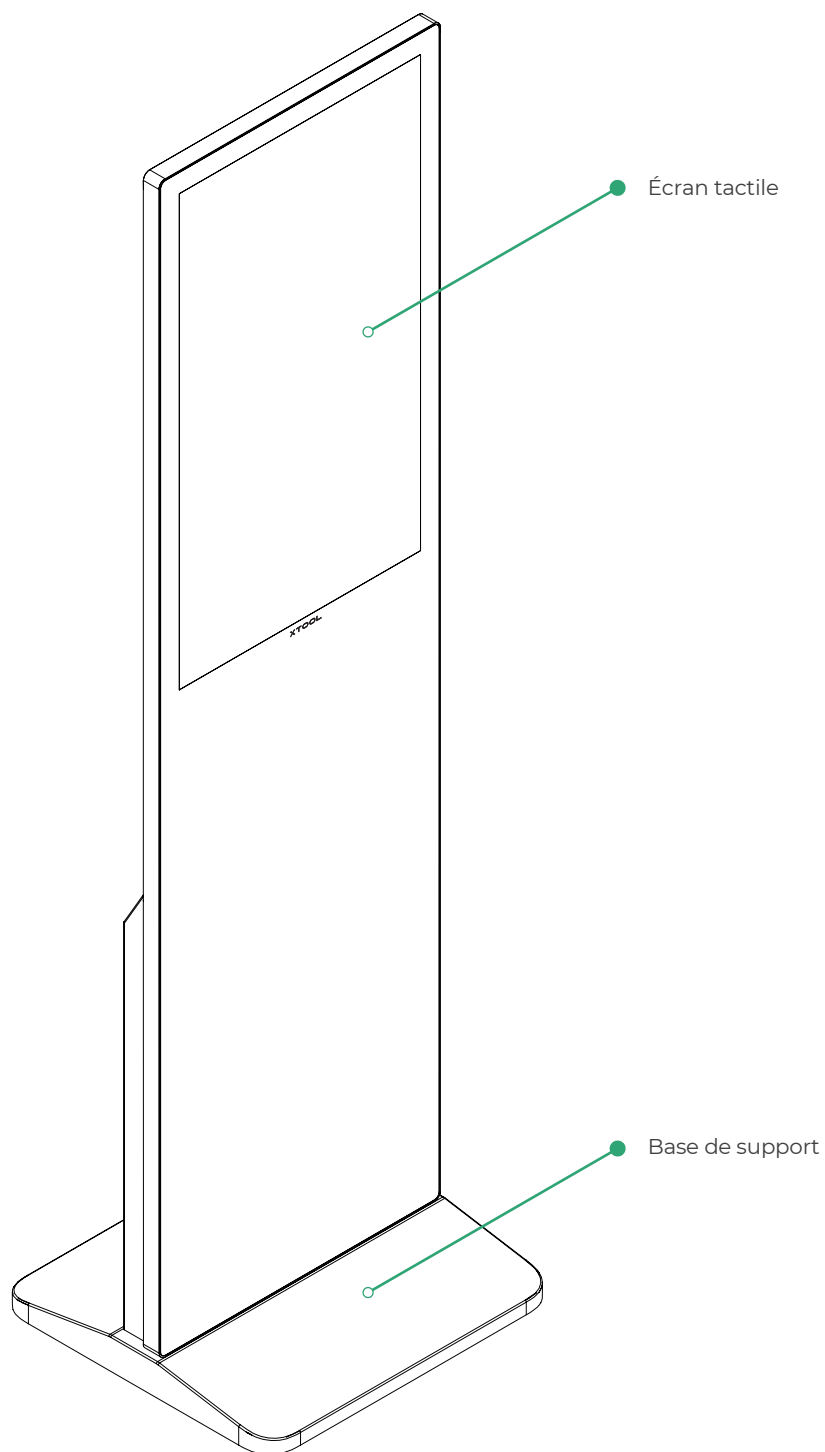

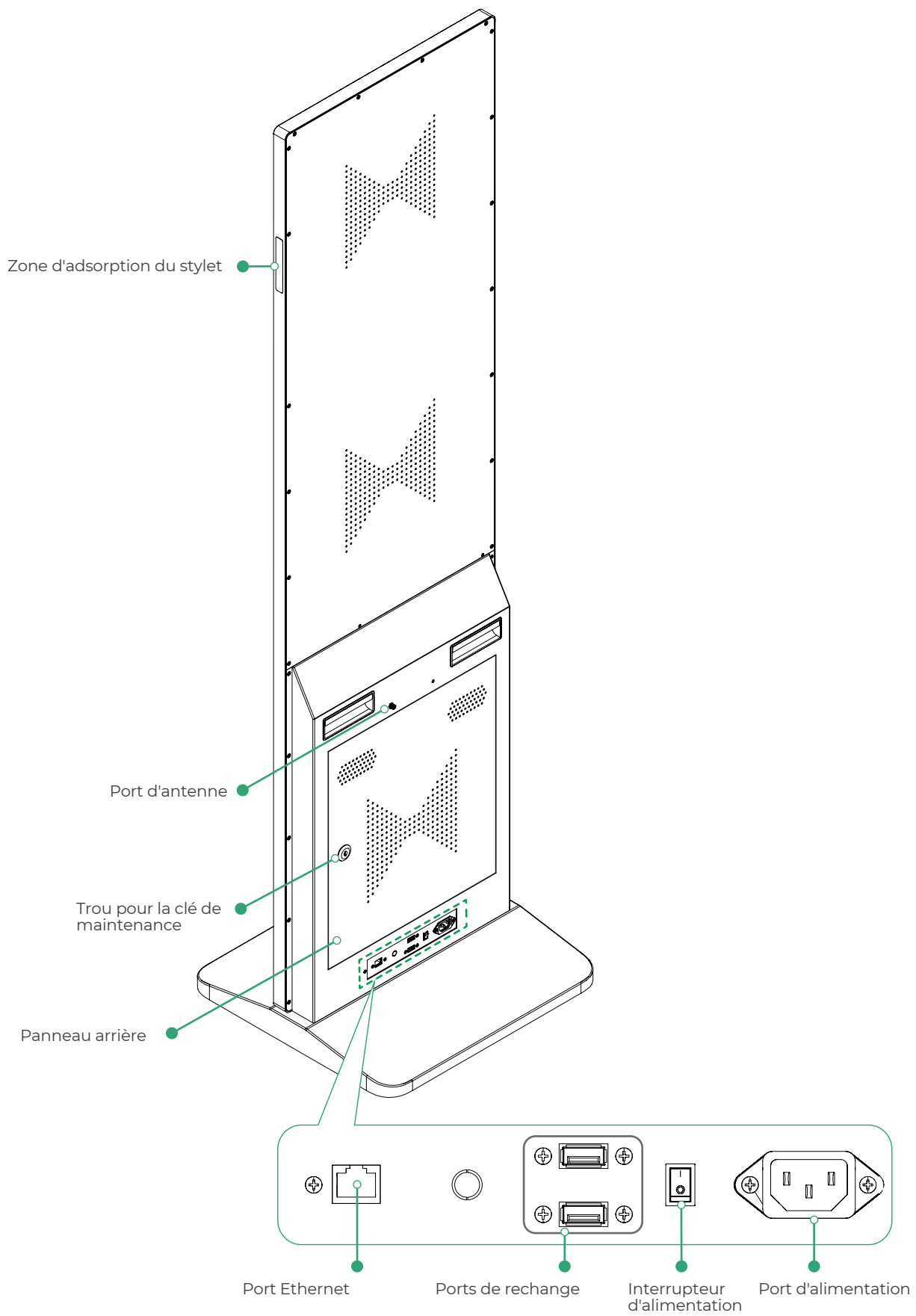

 Le panneau arrière ne peut être ouvert avec la clé de maintenance qu'en cas de réparation.

Installez le kiosque en libre-service sur pied xTool

1 Installez la base de support

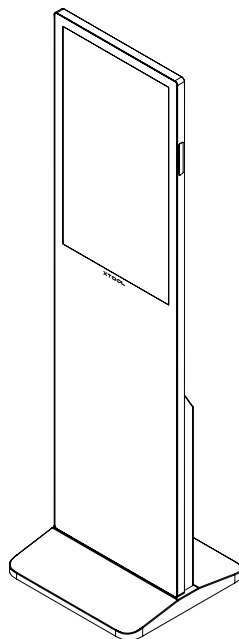
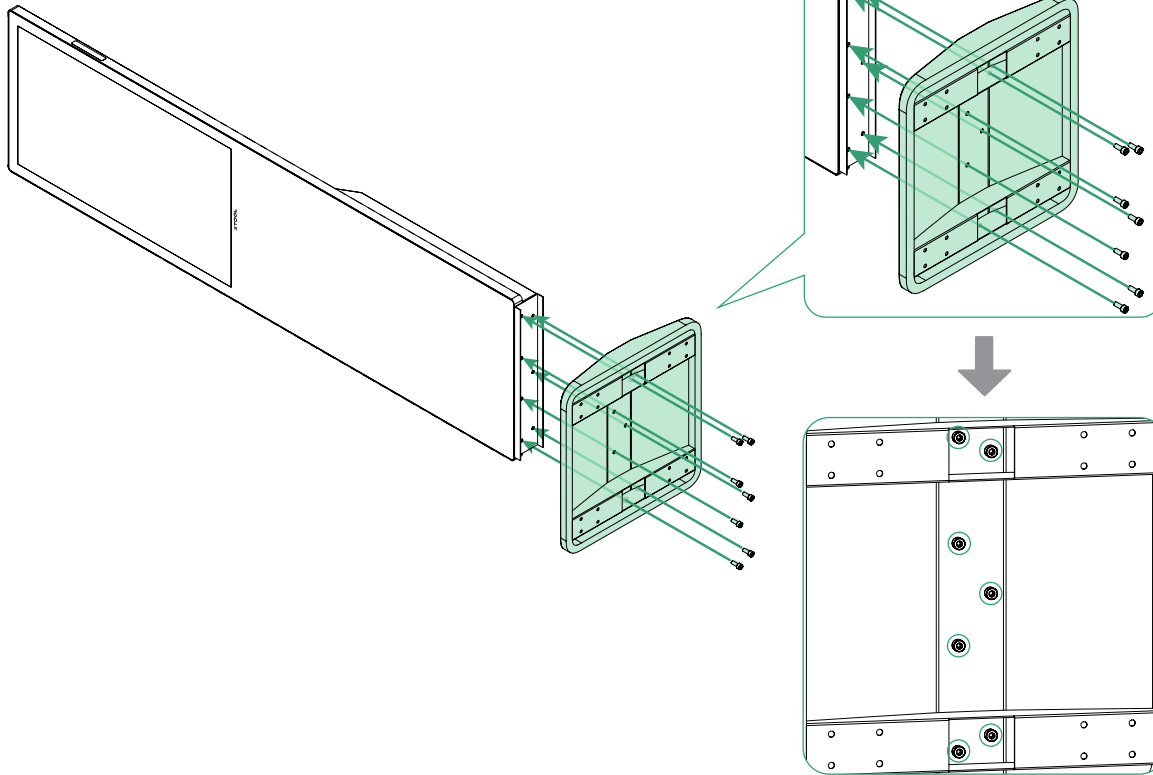
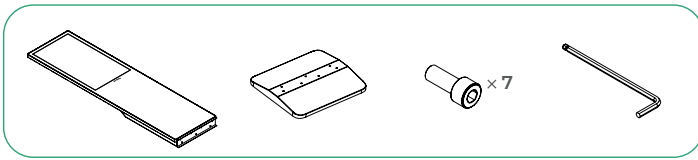

2 Installer l'antenne

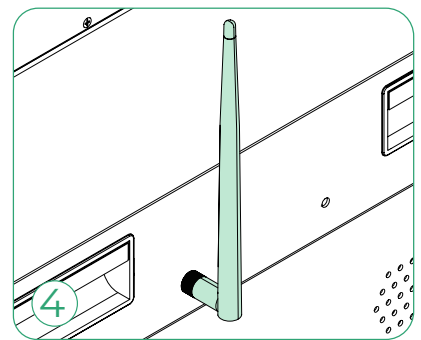
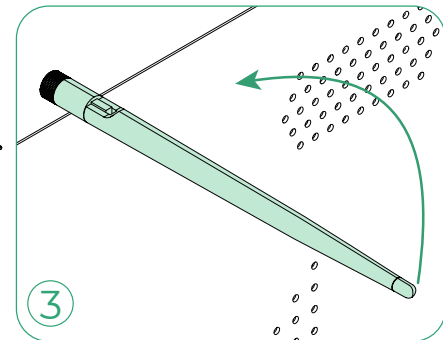
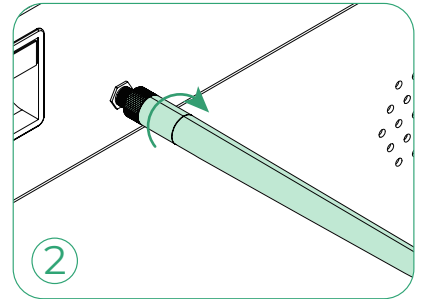
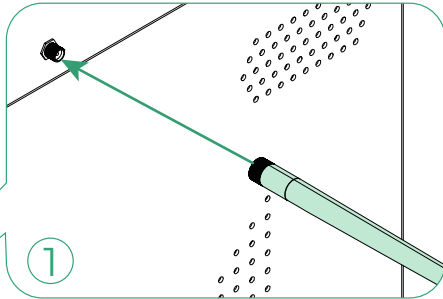
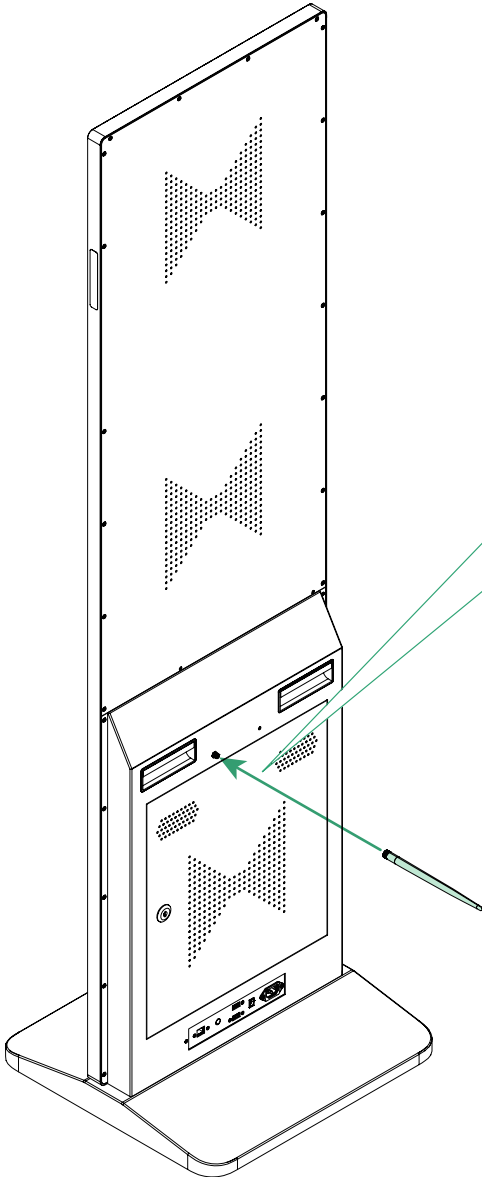
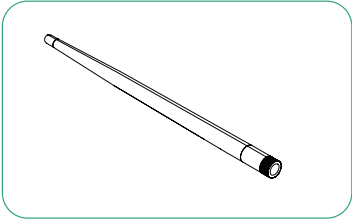

Utilisez le kiosque en libre-service sur pied xTool

Insérez le câble d'alimentation et allumez le kiosque

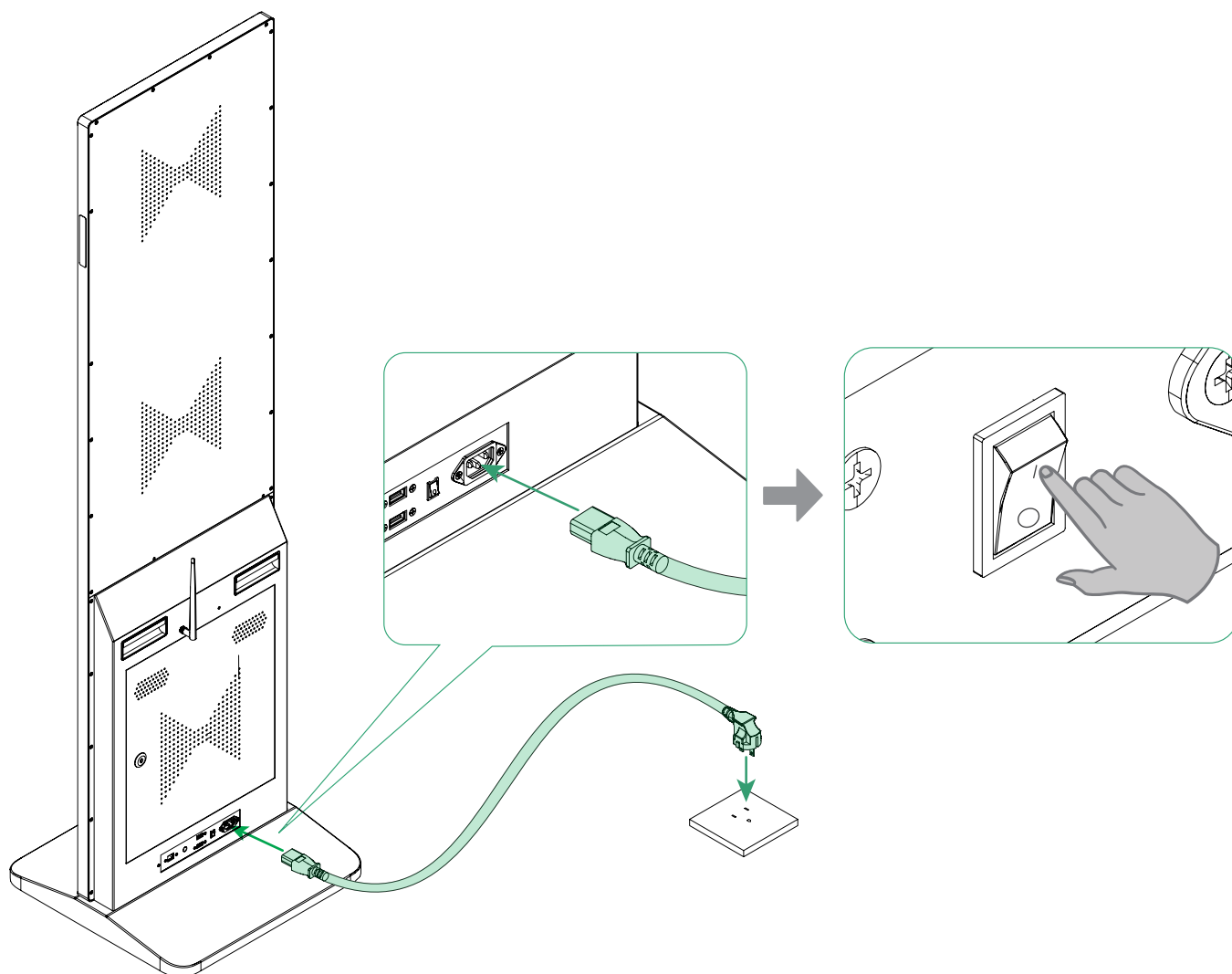
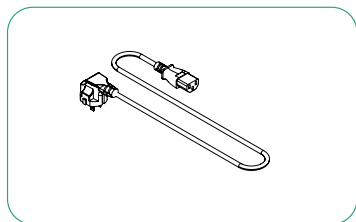



Scannez le code QR ou visitez le lien fourni pour apprendre à utiliser le produit avec les machines xTool pour le traitement.



support.xtool.com/article/2087

XTOOL